

2020-2021 Cattaraugus-Allegany BOCES Online Course Catalog



How it works

Step 1

Choose the course that fits your student using the online course catalog at the end of the slide deck.

Step 2

Fill out the [online student registration form](#) and the downloadable [student contract](#).

Step 3

Set up a time with a distance learning teacher for student orientation.

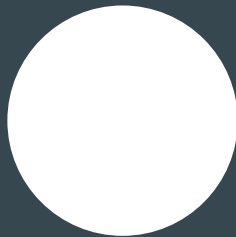

New High School Electives



BUSINESS LAW

HALF-CREDIT ELECTIVE

This semester-long high school course is designed to provide students with the knowledge of some of the vital legal concepts that affect commerce and trade, after first gaining some familiarity with how laws are created and interpreted. Students are then introduced to the types of businesses that can be created as well as the contractual and liability considerations that can impact a business. Laws that affect how a business is regulated are reviewed, particularly the impact of administrative rules and regulations on a business. Global commerce and international agreements, treaties, organizations, and courts are discussed to get a better sense of what it means to “go global” with a business. Dispute resolution strategies are also addressed.

.....

INTRODUCTION TO AGRICULTURE, FOOD, AND NATURAL RESOURCES

HALF-CREDIT ELECTIVE

This semester-length high school course introduces students to the basic scientific principles of agriculture and natural resources. Students recognize and research plant systems, animal systems, government policy, “green” technologies, agribusiness principles, and sustainability systems. In this course, students apply understanding of ecosystems and systems thinking to the management of natural resources to maximize the health and productivity of the environment, agriculture, and communities. Students also analyze community practice or policy development related to sustainability in agriculture, food, and natural resources. Finally, students apply adaptive ecosystem management to a common pool resource problem in a manner that addresses ecological, socioeconomic, and institutional contexts.

New High School Electives

INTRODUCTION TO CAREERS IN ARCHITECTURE AND CONSTRUCTION

HALF-CREDIT ELECTIVE

The goal of this semester-long high school course is to provide students with an overview of careers in architecture and construction in order to assist with informed career decisions. This dynamic, rapidly evolving career cluster is comprised of three pathways (fields): Design and Pre-Construction (Architecture and Engineering); Construction (Construction and Extraction); and Maintenance and Operations (Installation, Maintenance, and Repair). The Architecture and Construction career cluster is defined as careers in building, designing, managing, maintaining, and planning the built environment. The built environment encompasses all zones of human activity—from natural conservation areas with minimal human intervention to highly dense areas with tall skyscrapers and intricate highway systems to suburban cul-de-sacs.

INTRODUCTION TO CAREERS IN FINANCE

HALF-CREDIT ELECTIVE

Introduction to Careers in Finance is a semester-long course that provides the fundamentals of the financial services industry in the United States and explores the jobs and career opportunities that the industry offers. Course units address a broad set of services in the industry including finance overview, financial services, securities analysis, investments, principles of corporate finance, banking services, risk management, and insurance.

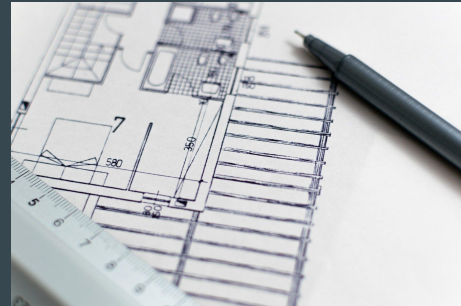

New High School Electives

INTRODUCTION TO STEM

HALF-CREDIT ELECTIVE

This semester-long course introduces students to the four areas of Science, Technology, Engineering, and Mathematics through an interdisciplinary approach that will increase awareness, build knowledge, develop problem solving skills, and potentially awaken an interest in pursuing a career in STEM. Students are introduced to the history, fundamental principles, applications, processes, and concepts of STEM. Students are exposed to several computer applications used to analyze and present technical or scientific information. Finally, students explore the kinds of strategies frequently used to solve problems in these disciplines. Throughout the course, students discover their strengths through practical applications and awareness of the various STEM careers.

LAW ENFORCEMENT FIELD SERVICES

HALF-CREDIT ELECTIVE

This semester-long course introduces students to the field of law enforcement and the local, county, state, and federal laws that law enforcement personnel are sworn to uphold. The students also gain an understanding of the career options available in this field and the skills, education, and background experience needed to succeed. Students learn about the evolution of the role of law enforcement in the United States including key changes affecting law enforcement. Students learn about the interaction between local, county, state, and federal law enforcement agencies. Finally, students learn about the types of crime that are commonly committed and the procedures, evidence collection techniques, and technological advances that law enforcement personnel use to investigate crimes.

.....



AP Courses

AP Art History*

AP Biology AB*

AP Calculus AB*

AP Calculus BC*

AP Chemistry*

AP Computer Science*

AP English Language and Composition*

AP English Literature and Composition*

AP Environmental Science*

AP French Language and Culture*

AP Human Geography*

AP Macroeconomics

AP Microeconomics

AP Psychology*

AP Spanish Language and Culture*

AP Statistics*

AP United State Government and Politics

AP United States History*

AP World History*

*option for 1 credit available

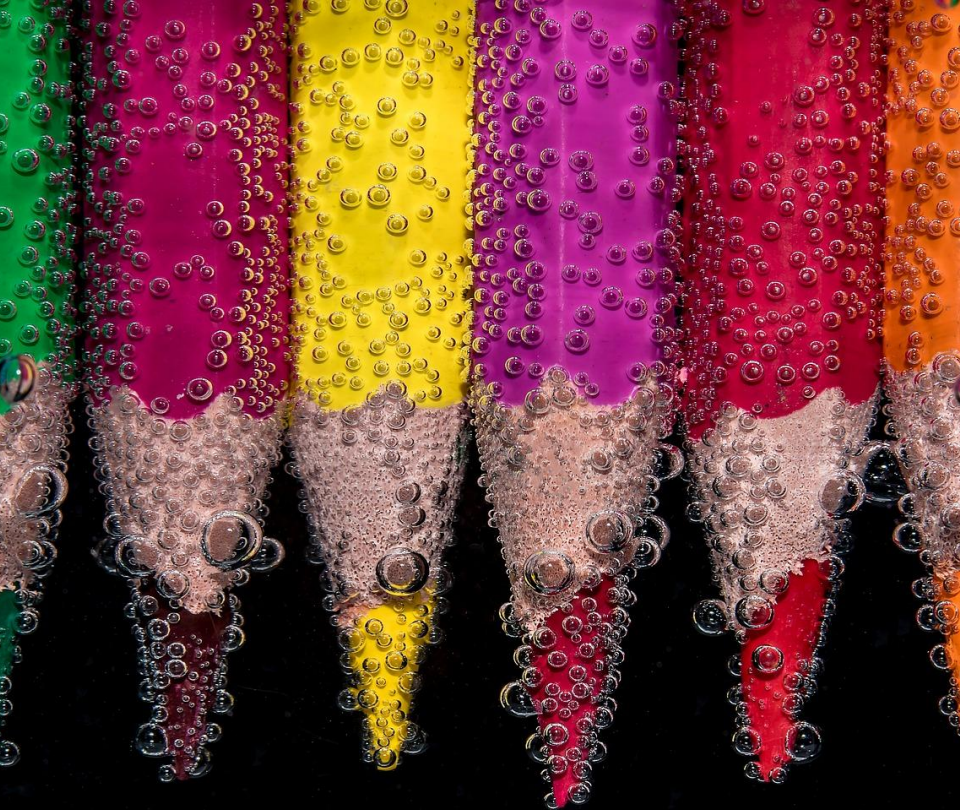

Art, Visual Arts, & Music

Art History *

Art in World Cultures

Introduction to Art*

Fine Art*

Music Appreciation

*option for 1 credit available

Career & Business

Advertising and Sales Promotion

Agriscience I and II

Business Law

Career Exploration

Careers in Criminal Justice

Career Planning and Development*

Cosmetology

Dental Assisting 1, 2, and 3

Early Childhood Education

Fashion and Interior Design

Fire and Emergency Services

Forestry and Natural Resources

Accounting I and 2

Health Science Concepts*

Hospitality and Tourism

International Business



Introduction to Agriculture, Food, and Natural Resources

Introduction to Careers in Architecture and Construction

Introduction to Careers in Finance

Introduction to Culinary Arts

Introduction to Entrepreneurship I and II

Introduction to Health Science*

Introduction to Manufacturing: Product Design & Innovation

Introduction to Military Careers

Introduction to STEM

Law Enforcement Field Services

Manufacturing Process Development

Manufacturing Product Development

Medical Terminology

Microsoft Office Specialist*

Principles of Public Service: To Serve and Protect

Principles of Agriculture, Food, and Natural Resources

Sports and Entertainment Marketing

Veterinary Science

*option for 1 credit available



Digital Arts Electives

[2D Animation](#)

[3D Modeling](#)

[Animation](#)

[Digital Arts](#)

[Digital Photography I](#)

[Digital Photography II](#)

[Game Design IA](#)

[Game Design IB](#)

*option for 1 credit available

English



Creative Writing

English Language Arts 9th*

English Language Arts 10th*

English Language Arts 11th*

English Language Arts 12th*

Expository Reading and Writing*

IDEA Writing

Introduction to Communications and Speech

Gothic Literature: Monster Stories

Journalism

Literacy and Comprehension I*

Literacy and Comprehension II*

Public Speaking

*option for 1 credit available

спасибо 谢谢
GRACIAS 谢谢
THANK YOU
ありがとうございました MERC
DANKE धन्यवाद
شُكْرًا OBRIGAD

Foreign Language

Arabic 1*

Arabic 2*

Arabic 3*

French 1*

French 2*

French 3*

German 1*

German 2*

German 3*

Latin 1*

Latin 2*

Mandarin 1*

Mandarin 2*

Mandarin 3*

Spanish 1*

Spanish 2*

Spanish 3*

Spanish 4*^

*option for 1 credit available

^Fuel Ed Course, not available in sequence through ASU



Health & Physical Education

Contemporary Health
Exercise Science
First Aid & Safety
Fitness Fundamentals I*
Flexibility Training
Group Sports
Individual Sports
Intro to Coaching
Lifetime Fitness*
Personal Health and Fitness
Personal Training Concepts
Sports Officiating
Walking Fitness

*option for 1 credit available

Life Skills



Introduction to Social Media

Family and Consumer Science

Life Skills

Nutrition and Wellness

Peer Counseling

Reaching Your Academic Potential

Real World Parenting

Online Learning and Digital Citizenship

*option for 1 credit available



Trigonometry

*option for 1 credit available

Science



NGSS Life Science (MS)*

NGSS Earth Science*

NGSS Physical Science*

NGSS Biology*

NGSS Chemistry*

NGSS Physics*

Anatomy and Physiology*

Astronomy

Biotechnology

Environmental Science*

Forensics Science

Great Minds in Science

Marine Science

*option for 1 credit available

Social Studies



Survey of World History*

Modern World History*

U.S. History I*

U.S. History II*

Survey of US History*

U.S. Government

Economics

African American History

Anthropology

Archaeology

Criminology

Human Geography*

History of the Holocaust

Law and Order: Introduction to Legal Studies

Mythology and Folklore

Psychology*

Philosophy

Social Problems I

Social Problems 2

Sociology

World Religions

*option for 1 credit available

Computer Science, Engineering, & Technology



Please be advised that Technology Electives may require the purchase of additional software.

C++ Programming

Computer Fundamentals*

Computer Science (Python) 1

Computer Science 2

Concepts of Engineering and Technology

Cybersecurity

Introduction to Information Technology*

Java Programming*

Programming Logic and Design

Web Design*

*option for 1 credit available

CA BOCES Distance Learning Team



Karen Insley

karen_insley@caboces.org



Christina McGee

christina_mcgee@caboces.org



Lisa Scott

lisa_scott@caboces.org



Tiffany Turner

tiffany_turner@caboces.org